



## Valves for radiators and accessories 07

07





Installation of thermostatic and thermo-electric heads is very simple. It can be carried out by removing the handle and the plastic component.

Unscrew the handle (1), insert the green extractor on the stainless steel pin (2) and re-screw the handle (3). In this way it is possible to remove the handle and the plastic component without damaging them in order to install the desired head.



It is possible to replace the sealing O-ring within the body of the valve without draining down the system.

The nominal diameter and the water flow direction are indicated on each valve body.



Terminals have a conical thread and are provided with Loctite® Dri-Seal 5061 which guarantees the seal on the standard thread.

CONICAL THREAD WITH LOCTITE® DRI-SEAL® 5061  
SEAT IN HPF



A seal between terminal and body is achieved by means of an HPF seat, which guarantees reliability and durability.

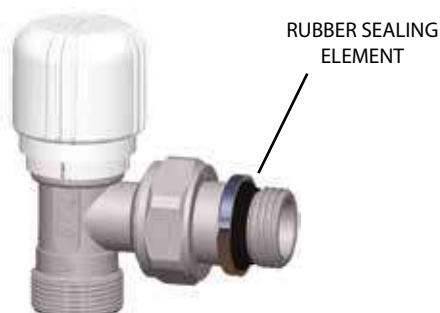

Far offers new unions with rubber sealing that allow installation on radiators without the use of hemp or PTFE sealing.

#### INSTALLATION OVERVIEW

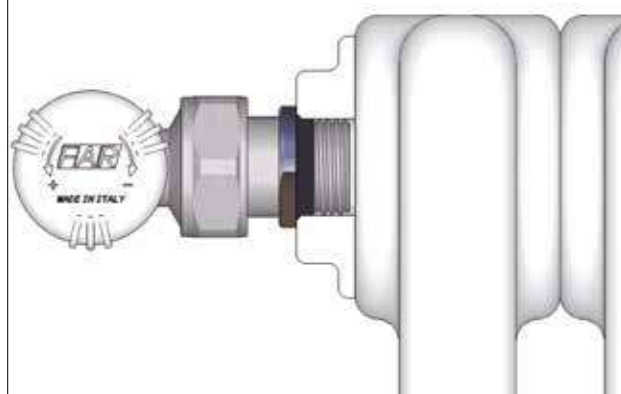

#### INSTALLABLE COMPONENTS

FAR manual valves and lockshield valves are available with iron connection and with interchangeable connections for copper, plastic and multilayer pipe.



For easier installation, FAR offers a special range of spare parts:

ART. 8820	ART. 8850	ART. 8870	ART. 8900	ART. 5560
TELESCOPIC TERMINAL	STRAIGHT EXTENSION	REDUCER	SPECIAL ELBOW WITH Ø16 CUT PIPE	ECCENTRIC FITTING
To cover the distance between valve and radiator 3/8": from 32mm to 55mm 1/2" - 3/4": from 35mm to 60mm	Enables changing a FAR 24x19 thread in a Ø 18-22 connection for copper pipe. Available with 30-35-40 mm extension	Enables changing a FAR 24X19 thread in a 1/2" female thread	Available in 30 and 100 mm lengths	Available sizes: 1-2-3-4-5-6 cm with 3/8"-1/2"-3/4" thread

Chrome-plated angled thermostatic valve with horizontal control.

- interchangeable sizes for copper, plastic and multilayer pipe
- easy extraction system for manual regulating valve
- stainless steel pin with double sealing O-ring
- strengthened back spring and flat lock
- terminal provided with Loctite® Dri-Seal® 5061

**ART. 1615**

Code	size	€	box	pack
1615 38	3/8"		5	150
1615 12	1/2"		5	150



Chrome-plated angled thermostatic valve with horizontal control.

- iron pipe connection
- easy extraction system for manual regulating valve
- stainless steel pin with double sealing O-ring
- strengthened back spring and flat lock
- terminal provided with Loctite® Dri-Seal® 5061

**ART. 1625**

Code	size	€	box	pack
1625 12	1/2"		5	150



Chrome-plated thermostatic valve, left-angled version.

- interchangeable sizes for copper, plastic and multilayer pipe
- easy extraction system for manual regulating valve
- stainless steel pin with double sealing O-ring
- strengthened back spring and flat lock
- terminal provided with Loctite® Dri-Seal® 5061

**ART. 1616**

Code	size	€	box	pack
1616 38	3/8"		10	100
1616 12	1/2"		10	100



Chrome-plated lockshield valve, right-angled version.

- interchangeable sizes for copper, plastic and multilayer pipe
- brass covering cap
- double sealing O-ring on the arm
- metallic sealing lock and O-ring seal
- terminal provided with Loctite® Dri-Seal® 5061

**ART. 1117**

Code	size	€	box	pack
1117 38	3/8"		10	100
1117 12	1/2"		10	100



Chrome-plated thermostatic valve, left-angled version.

- iron pipe connection
- easy extraction system for manual regulating valve
- stainless steel pin with double sealing O-ring
- strengthened back spring and flat lock
- terminal provided with Loctite® Dri-Seal® 5061

**ART. 1626**

Code	size	€	box	pack
1626 38	3/8"		10	100
1626 12	1/2"		10	100



Chrome-plated lockshield valve, right-angled version.

- iron pipe connection
- brass covering cap
- double sealing O-ring on the arm
- metallic sealing lock and O-ring seal
- terminal provided with Loctite® Dri-Seal® 5061

**ART. 1127**

Code	size	€	box	pack
1127 38	3/8"		10	100
1127 12	1/2"		10	100



Chrome-plated thermostatic valve, right-angled version.

- interchangeable sizes for copper, plastic and multilayer pipe
- easy extraction system for manual regulating valve
- stainless steel pin with double sealing O-ring
- strengthened back spring and flat lock
- terminal provided with Loctite® Dri-Seal® 5061

**ART. 1617**

Code	size	€	box	pack
1617 38	3/8"		10	100
1617 12	1/2"		10	100



Chrome-plated lockshield valve, left-angled version.

- interchangeable sizes for copper, plastic and multilayer pipe
- brass covering cap
- double sealing O-ring on the arm
- metallic sealing lock and O-ring seal
- terminal provided with Loctite® Dri-Seal® 5061

**ART. 1116**

Code	size	€	box	pack
1116 38	3/8"		10	100
1116 12	1/2"		10	100



Chrome-plated thermostatic valve, right-angled version.

- iron pipe connection
- easy extraction system for manual regulating valve
- stainless steel pin with double sealing O-ring
- strengthened back spring and flat lock
- terminal provided with Loctite® Dri-Seal® 5061

**ART. 1627**

Code	size	€	box	pack
1627 38	3/8"		10	100
1627 12	1/2"		10	100



Chrome-plated lockshield valve, left-angled version.

- iron pipe connection
- brass covering cap
- double sealing O-ring on the arm
- metallic sealing lock and O-ring seal
- terminal provided with Loctite® Dri-Seal® 5061

**ART. 1126**

Code	size	€	box	pack
1126 38	3/8"		10	100
1126 12	1/2"		10	100



Chrome-plated angled thermostatic valve with horizontal control.

- interchangeable sizes for copper, plastic and multilayer pipe
- easy extraction system for manual regulating valve
- stainless steel pin with double sealing O-ring
- strengthened back spring and flat lock
- terminal provided with EPDM gasket

**ART. 1635**

Code	size	€	box	pack
1635 38	3/8"		5	150
1635 12	1/2"		5	150



Chrome-plated angled thermostatic valve with horizontal control.

- iron pipe connection
- easy extraction system for manual regulating valve
- stainless steel pin with double sealing O-ring
- strengthened back spring and flat lock
- terminal provided with EPDM gasket

**ART. 1645**

Code	size	€	box	pack
1645 12	1/2"		5	150



Chrome-plated thermostatic valve, left-angled version.

- interchangeable sizes for copper, plastic and multilayer pipe
- easy extraction system for manual regulating valve
- stainless steel pin with double sealing O-ring
- strengthened back spring and flat lock
- terminal provided with EPDM gasket

**ART. 1636**

Code	size	€	box	pack
1636 38	3/8"		10	100
1636 12	1/2"		10	100



Chrome-plated lockshield valve, right-angled version.

- interchangeable sizes for copper, plastic and multilayer pipe
- brass covering cap
- double sealing O-ring on the arm
- metallic sealing lock and O-ring seal
- terminal provided with EPDM gasket

**ART. 1137**

Code	size	€	box	pack
1137 38	3/8"		10	100
1137 12	1/2"		10	100



Chrome-plated thermostatic valve, left-angled version.

- iron pipe connection
- easy extraction system for manual regulating valve
- stainless steel pin with double sealing O-ring
- strengthened back spring and flat lock
- terminal provided with EPDM gasket

**ART. 1646**

Code	size	€	box	pack
1646 38	3/8"		10	100
1646 12	1/2"		10	100



Chrome-plated lockshield valve, right-angled version.

- iron pipe connection
- brass covering cap
- double sealing O-ring on the arm
- metallic sealing lock and O-ring seal
- terminal provided with EPDM gasket

**ART. 1147**

Code	size	€	box	pack
1147 38	3/8"		10	100
1147 12	1/2"		10	100



Chrome-plated thermostatic valve, right-angled version.

- interchangeable sizes for copper, plastic and multilayer pipe
- easy extraction system for manual regulating valve
- stainless steel pin with double sealing O-ring
- strengthened back spring and flat lock
- terminal provided with EPDM gasket

**ART. 1637**

Code	size	€	box	pack
1637 38	3/8"		10	100
1637 12	1/2"		10	100



Chrome-plated lockshield valve, left-angled version.

- interchangeable sizes for copper, plastic and multilayer pipe
- brass covering cap
- double sealing O-ring on the arm
- metallic sealing lock and O-ring seal
- terminal provided with EPDM gasket

**ART. 1136**

Code	size	€	box	pack
1136 38	3/8"		10	100
1136 12	1/2"		10	100



Chrome-plated thermostatic valve, right-angled version.

- iron pipe connection
- easy extraction system for manual regulating valve
- stainless steel pin with double sealing O-ring
- strengthened back spring and flat lock
- terminal provided with EPDM gasket

**ART. 1647**

Code	size	€	box	pack
1647 38	3/8"		10	100
1647 12	1/2"		10	100



Chrome-plated lockshield valve, left-angled version.

- iron pipe connection
- brass covering cap
- double sealing O-ring on the arm
- metallic sealing lock and O-ring seal
- terminal provided with EPDM gasket

**ART. 1146**

Code	size	€	box	pack
1146 38	3/8"		10	100
1146 12	1/2"		10	100





Chrome-plated angled thermostatic valve.

- interchangeable sizes for copper, plastic and multilayer pipe
- easy extraction system for manual regulating valve
- stainless steel pin with double sealing O-ring
- strengthened back spring and flat lock
- terminal provided with Loctite® Dri-Seal® 5061

## ART. 1610



Code	size	€	box	pack
1610 38	3/8"		10	50
1610 12	1/2"		10	50

Chrome-plated angled lockshield valve.

- interchangeable sizes for copper, plastic and multilayer pipe
- brass covering cap
- double sealing O-ring on the arm
- metallic sealing lock and O-ring seal
- terminal provided with Loctite® Dri-Seal® 5061

## ART. 1100



Code	size	€	box	pack
1100 38	3/8"		10	50
1100 12	1/2"		10	50

Chrome-plated straight thermostatic valve.

- interchangeable sizes for copper, plastic and multilayer pipe
- easy extraction system for manual regulating valve
- stainless steel pin with double sealing O-ring
- strengthened back spring and flat lock
- terminal provided with Loctite® Dri-Seal® 5061

## ART. 1630



Code	size	€	box	pack
1630 38	3/8"		10	50
1630 12	1/2"		10	50

Chrome-plated straight lockshield valve.

- interchangeable sizes for copper, plastic and multilayer pipe
- brass covering cap
- double sealing O-ring on the arm
- metallic sealing lock and O-ring seal
- terminal provided with Loctite® Dri-Seal® 5061

## ART. 1300



Code	size	€	box	pack
1300 38	3/8"		10	50
1300 12	1/2"		10	50

Chrome-plated angled thermostatic valve.

- iron pipe connection
- easy extraction system for manual regulating valve
- stainless steel pin with double sealing O-ring
- strengthened back spring and flat lock
- terminal provided with Loctite® Dri-Seal® 5061

## ART. 1620



Code	size	€	box	pack
1620 38	3/8"		10	50
1620 12	1/2"		10	50
1620 34	3/4"		10	50
1620 1	1"		5	40

Chrome-plated angled lockshield valve.

- iron pipe connection
- brass covering cap
- double sealing O-ring on the arm
- metallic sealing lock and O-ring seal
- terminal provided with Loctite® Dri-Seal® 5061

## ART. 1200



Code	size	€	box	pack
1200 38	3/8"		10	50
1200 12	1/2"		10	50
1200 34	3/4"		5	50
1200 1	1"		5	40

Chrome-plated straight thermostatic valve.

- iron pipe connection
- easy extraction system for manual regulating valve
- stainless steel pin with double sealing O-ring
- strengthened back spring and flat lock
- terminal provided with Loctite® Dri-Seal® 5061

## ART. 1640



Code	size	€	box	pack
1640 38	3/8"		10	50
1640 12	1/2"		10	50
1640 34	3/4"		10	50
1640 1	1"		5	40

Chrome-plated straight lockshield valve.

- iron pipe connection
- brass covering cap
- double sealing O-ring on the arm
- metallic sealing lock and O-ring seal
- terminal provided with Loctite® Dri-Seal® 5061

## ART. 1400



Code	size	€	box	pack
1400 38	3/8"		10	50
1400 12	1/2"		10	50
1400 34	3/4"		5	50
1400 1	1"		5	40

Chrome-plated angled thermostatic valve.

- interchangeable sizes for copper, plastic and multilayer pipe
- easy extraction system for manual regulating valve
- stainless steel pin with double sealing O-ring
- strengthened back spring and flat lock
- terminal provided with EPDM gasket

**ART. 1611**

Code	size	€	box	pack
1611 38	3/8"		10	50
1611 12	1/2"		10	50

Chrome-plated angled lockshield valve.

- interchangeable sizes for copper, plastic and multilayer pipe
- brass covering cap
- double sealing O-ring on the arm
- metallic sealing lock and O-ring seal
- terminal provided with EPDM gasket

**ART. 1111**

Code	size	€	box	pack
1111 38	3/8"		10	50
1111 12	1/2"		10	50

Chrome-plated straight thermostatic valve.

- interchangeable sizes for copper, plastic and multilayer pipe
- easy extraction system for manual regulating valve
- stainless steel pin with double sealing O-ring
- strengthened back spring and flat lock
- terminal provided with EPDM gasket

**ART. 1631**

Code	size	€	box	pack
1631 38	3/8"		10	50
1631 12	1/2"		10	50

Chrome-plated straight lockshield valve.

- interchangeable sizes for copper, plastic and multilayer pipe
- brass covering cap
- double sealing O-ring on the arm
- metallic sealing lock and O-ring seal
- terminal provided with EPDM gasket

**ART. 1311**

Code	size	€	box	pack
1311 38	3/8"		10	50
1311 12	1/2"		10	50

Chrome-plated angled thermostatic valve.

- iron pipe connection
- easy extraction system for manual regulating valve
- stainless steel pin with double sealing O-ring
- strengthened back spring and flat lock
- terminal provided with EPDM gasket

**ART. 1621**

Code	size	€	box	pack
1621 38	3/8"		10	50
1621 12	1/2"		10	50

Chrome-plated angled lockshield valve.

- iron pipe connection
- brass covering cap
- double sealing O-ring on the arm
- metallic sealing lock and O-ring seal
- terminal provided with EPDM gasket

**ART. 1211**

Code	size	€	box	pack
1211 38	3/8"		10	50
1211 12	1/2"		10	50

Chrome-plated straight thermostatic valve.

- iron pipe connection
- easy extraction system for manual regulating valve
- stainless steel pin with double sealing O-ring
- strengthened back spring and flat lock
- terminal provided with EPDM gasket

**ART. 1641**

Code	size	€	box	pack
1641 38	3/8"		10	50
1641 12	1/2"		10	50

Chrome-plated straight lockshield valve.

- iron pipe connection
- brass covering cap
- double sealing O-ring on the arm
- metallic sealing lock and O-ring seal
- terminal provided with EPDM gasket

**ART. 1411**

Code	size	€	box	pack
1411 38	3/8"		10	50
1411 12	1/2"		10	50

# 7 THERMOSTATIC VALVES AND LOCKSHIELD VALVES

Chrome-plated angled thermostatic valve with PRESETTING.

- interchangeable sizes for copper, plastic and multilayer pipe
- easy extraction system for manual regulating valve
- stainless steel pin with double sealing O-ring
- strengthened back spring and flat lock
- numbered ring for setting
- regulating key
- terminal provided with EPDM gasket

## ART. 1618



Code	size	€	box	pack
1618 38	3/8"		1	100
1618 12	1/2"		1	100

Chrome-plated straight thermostatic valve with PRESETTING.

- interchangeable sizes for copper, plastic and multilayer pipe
- easy extraction system for manual regulating valve
- stainless steel pin with double sealing O-ring
- strengthened back spring and flat lock
- numbered ring for setting
- regulating key
- terminal provided with EPDM gasket

## ART. 1638



Code	size	€	box	pack
1638 38	3/8"		1	100
1638 12	1/2"		1	100

Chrome-plated angled thermostatic valve with PRESETTING.

- iron pipe connection
- easy extraction system for manual regulating valve
- stainless steel pin with double sealing O-ring
- strengthened back spring and flat lock
- numbered ring for setting
- regulating key
- terminal provided with EPDM gasket

## ART. 1628



Code	size	€	box	pack
1628 38	3/8"		1	100
1628 12	1/2"		1	100
1628 34	3/4"		1	50

Chrome-plated straight thermostatic valve with PRESETTING.

- iron pipe connection
- easy extraction system for manual regulating valve
- stainless steel pin with double sealing O-ring
- strengthened back spring and flat lock
- numbered ring for setting
- regulating key
- terminal provided with EPDM gasket

## ART. 1648



Code	size	€	box	pack
1648 38	3/8"		1	100
1648 12	1/2"		1	100
1648 34	3/4"		1	50

Thermostatic valves with presetting allow the water flow to the radiator to be divided by means of a shaped body. They are designed for installation of the thermostatic head.

Adjustment is carried out by removing the handle and rotating the body up to the black reference notch at the desired position (from 1 to 6, plus the 'N' condition of fully open).

The shape of the regulating body allows a default value for flow resistance to be set for each of the calibration positions.

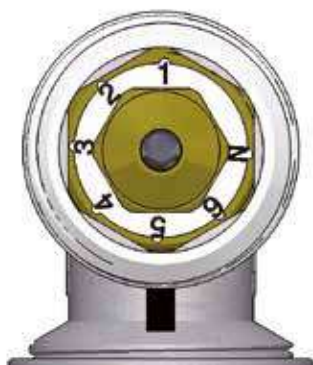

1. Completely unscrew the handle by turning it counterclockwise.



2. Insert the regulating key included in the package by matching the letter N on the key with the one on the valve.

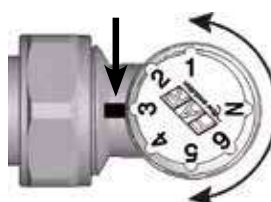

3. Turn the key clockwise or counter clockwise, moving it to the designed value at the reference notch.



4. Remove the key and replace the handle or the thermostatic head.



Thermostatic head with liquid sensor for FAR thermostatic valves.

- Temperature regulation range: from 7°C (\* position) to 28°C (5 position)
- Possibility to lock the head in the desired position.
- Possibility to restrict the setting range.
- Easy installation on the radiator valve.



## ART. 1828

Code	€	box	pack
1828		1	50

Certification EN215 (Keymark) in combination with valves Arts. 1620-1640 DN15

Anti-tamper guard for Art.1828.

Including:

- Allen key screw and nut
- Allen key



## ART. 1833

Code	€	box
1833		1

## SETTING AND INSTALLATION

### TEMPERATURE SETTING:

SELECTOR POSITION	TEMPERATURE
0	RADIATOR OFF
*	7°C
1	12°C
2	16°C
3	20°C
4	24°C
5	28°C

The setting reducers allow to lock the thermostatic head on the setting value (**picture A**) or to restrict the setting range (**picture B**)

**A** - The thermostatic head is locked on position 3.



**B** - The thermostatic head is limited between position 2 and 4



### Art.1833

#### ANTI-TAMPER GUARD for thermostatic head Art.1828

The anti-tamper guard art. 1833 allows to safely lock the FAR thermostatic head art.1828 on the set temperature value and to prevent the removal of the head by unauthorized people.

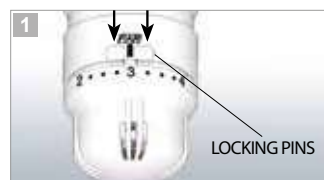

Set the desired value and lock the temperature by pushing the two pins on the head towards the numbered ring.

**NB: The two pins must always be placed towards the numbered selector in order to install the anti-tamper guard.**

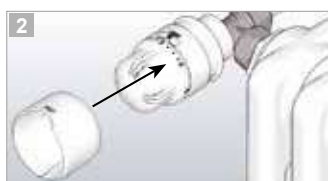

Place the anti-tamper guard in the right position, as shown in the picture.



Check the correct connection of the anti-tamper guard. The indicator must correspond with the desired number position.



Place the locking nut in the seat



Tighten the screw with the Allen key in order to lock the anti-tamper guard.

2 wired thermo-electric actuator provided with selector. Suitable for installation on thermostatic valves and manifolds.

- Chrome-plated ring with M30x1,5 thread
- Length connection cable: 75 cm
- Protection level: IP54

- NC = NORMALLY CLOSED
- NA = NORMALLY OPEN



N.B. For installation on thermostatic valves use the chrome-plated adapter, art. 1941.

### ART. 1909-1919-1929-1939

Code	voltage	opening time	type	€	box	pack
1909	24 V	180 s	NC		1	100
1919	230 V	180 s	NC		1	100
1929	24 V	180 s	NA		1	100
1939	230 V	180 s	NA		1	100

Chrome-plated adapter suitable for installation of electric actuators on thermostatic valves.

- M30x1,5 thread

### ART. 1941

Code	€	box
1941		1



Thermostatic control head. Remote sensor with liquid-filled element.

- remote selector
- length of capillary: 2 m.
- temperature range: 7°÷28°C

Provided with regulation scale numbered from 1 to 5, in order to choose the desired temperature.

### ART. 1800

Code	€	box	pack
1800		1	-



Thermostatic control head. Built-in sensor with liquid-filled element.

- temperature range: 7°÷28°C.

Provided with regulation scale numbered from 1 to 5, in order to choose the desired temperature.

Available in different finishing, see page 230

### ART. 1824

Code	€	box	pack
1824		1	100



Antitampering protection for art.1810.

### ART. 1830

Code	€	box
1830		1



4 wired thermo-electric actuator with auxiliary micro-switch and selector. Suitable for installation on thermostatic valves and manifolds.

- Chrome-plated ring with M30x1,5 thread
- Length connection cable: 75 cm
- Protection level: IP54

- NC = NORMALLY CLOSED



N.B. For installation on thermostatic valves use the chrome-plated adapter, art. 1941.

### ART. 1914-1924-1913-1923

Code	voltage	opening time	type	€	box	pack
1914	24 V	180 s	NC		1	100
1924	230 V	180 s	NC		1	100
1913	24 V	90 s	NC		1	100
1923	230 V	90 s	NC		1	100

Thermostatic control head. Remote sensor with liquid-filled element.

- remote selector
- length of capillary: 2 m.
- temperature range: 7°÷28°C

Provided with regulation scale numbered from 1 to 5, in order to choose the desired temperature.



### ART. 1810

Code	€	box
1810		1

Chrono-thermostatic head for FAR thermostatic valves.

- temperature range: 6 - 28° C
- battery operated ( 2x1,5V AA )
- backlight display
- weekly programmable clock
- open window function
- holiday/absence function
- antifreeze function



### ART. 1820

Code	€	box	pack
1820		1	25

Thermostatic control head. Built-in sensor with liquid-filled element and swiveling adapter.

- temperature range: 7°÷28°C.



### ART. 1834

Code	€	box	pack
1834		1	100

Antitampering protection for art. 1824. Complete with:

- Allen screw and nut
- Allen key

### ART. 1832

Code	€	box
1832		1



## THERMO-ELECTRIC HEADS

FAR thermo-electric heads are available in two versions: with auxiliary micro-switch (fig. B) or without (fig. A). These heads are activated or deactivated by a thermostat or a control unit. They are available in 'normally open' or 'normally closed' configurations with 24V or 230V voltage.

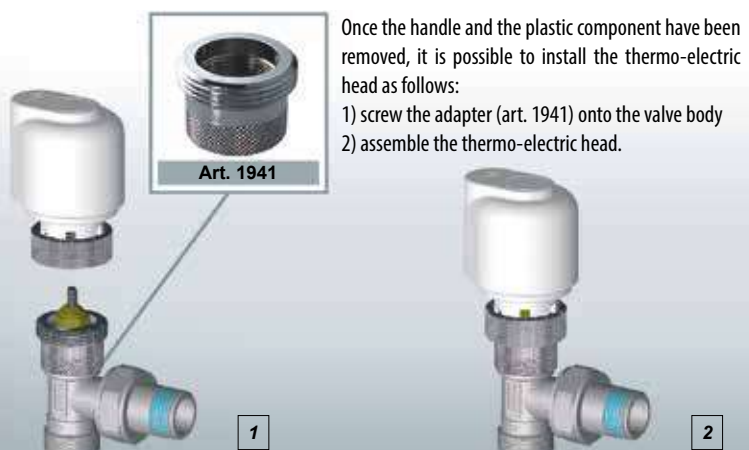

Once the handle and the plastic component have been removed, it is possible to install the thermo-electric head as follows:

- 1) screw the adapter (art. 1941) onto the valve body
- 2) assemble the thermo-electric head.

## THERMOSTATIC HEADS

The FAR thermostatic head is provided with a liquid sensor, which detects temperature variations and opens or closes the valve accordingly. It has a regulation scale numbered from 1 to 5 for selecting the desired temperature. Once the handle and the plastic component have been removed, it is possible to install the thermostatic head as follows:



1. position the selector on 5
2. fix the head on the valve body in the appropriate grooves
3. press the locking ring towards the valve to complete installation

SELECTOR POSITION	CORRESPONDING TEMPERATURE IN °C
0	EXCLUDED RADIATOR
*	7
1	12
2	16
3	20
4	24
5	28

The temperature selector can be locked on a particular value by using the locking key.



When installing thermostatic heads for use in systems serving public areas, an anti-tamper guard (art. 1832) is available.

Max. differential pressure:	1 bar
Reference point:	3 = 20° C
Max. room temperature:	50° C
Temperature range:	7-28° C
Antifreeze operation:	7° C
Hysteresis:	0,35 k
Response time - point 6.4.1.13 EN215:	23 min

To guarantee correct temperature sensing and regulation - even in situations where radiators are affected by other constraints within the room - FAR offers two other systems for detecting room temperature:



Art. 1800

### Main features:

- Thermostatic head with liquid sensor
  - Remote selector numbered from 1 to 5
  - Length of capillary: 2 m
  - Temperature range: 7° ÷ 28° C.
- (Values for temperatures are standard on all thermostatic models - see listing in the table for art. 1824)



Art. 1810

### Thermostatic head with sensor and graduated scale for selection of remote temperature value.

The sensor, which features a graduated temperature scale, is placed on the wall within 2m of the radiator. It should be located in an open area with no barriers to free movement of room air. This product is suitable for use with radiators located in recesses, concealed within decorative cabinets, or behind curtains of thick material where free circulation of room air is inhibited.

### Thermostatic head and remote sensor.

The sensor is placed at a maximum distance of 2m, usually on the skirting board under the radiator, in such a way as to be in the airflow drawn across the radiator or convactor as this will provide an average of the room air temperature of room air as a whole.

### SPACE-SAVING RADIATOR VALVES AND LOCKSHIELD VALVES

FAR offers various smart solutions to adapt to the available space. In case of a designer radiator, angled valves and lockshield valves can be installed in order to make the most of the space. The valve must be installed on the delivery line to the radiator and has to be selected according to the desired handle position, considering the radiator front view. In the example picture you can see a right-angled valve (art.1671), so that the handle or the thermostatic head are oriented to the right, once the valve is installed on the radiator.

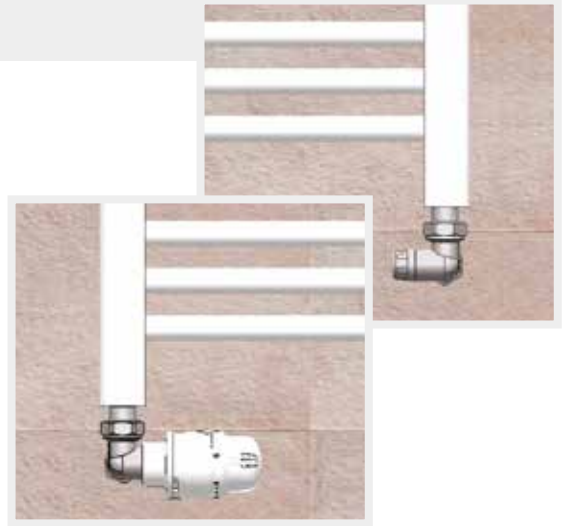

### SINGLE-DOUBLE PIPE VALVES

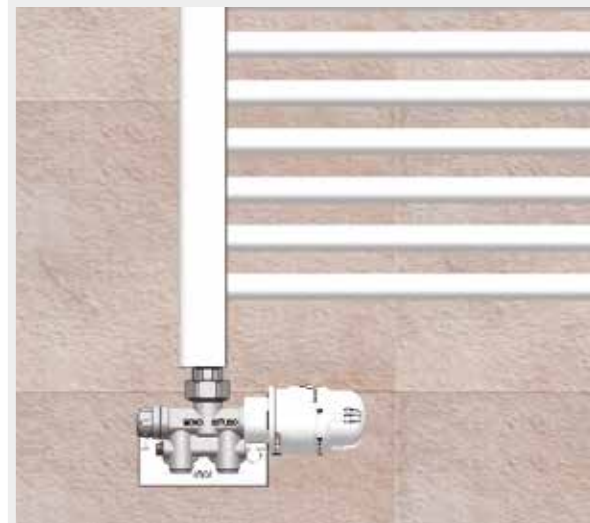

In case the system requires the installation of a single-double pipe valve, FAR offers right-hand and left-hand angled valves with adjustable by-pass. The valve must be installed on one side of the radiator and has to be selected according to the desired handle position, considering the radiator front view. In the example picture you can see a right-hand valve (art.1436), so that the handle or the thermostatic head are oriented to the right, once the valve is installed on the radiator.

### SINGLE-DOUBLE PIPE VALVES 50mm CENTRE DISTANCE

In case the radiator has connections with 50mm centre distance, a special single-double pipe angled valve with adjustable by-pass can be installed. Two types of adapters are available to connect the valve, according to the radiator connection. In the example picture you can see an angled valve (art.1482) with 24x19 FAR connection.

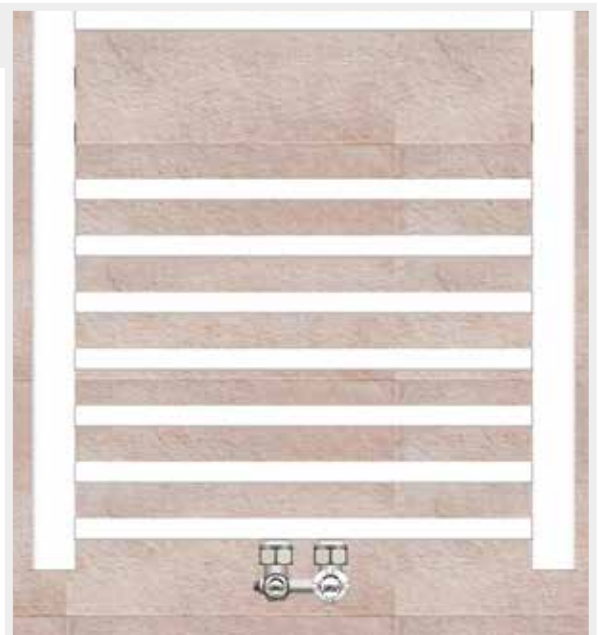

**INSTALLATION ADVICE FOR A BETTER SENSITIVITY OF THE THERMOSTATIC SENSOR**

In case of a single pipe valve with thermostatic head installed in a wall recess, the regulation could not be correct due to the sensor proximity to the heating body.

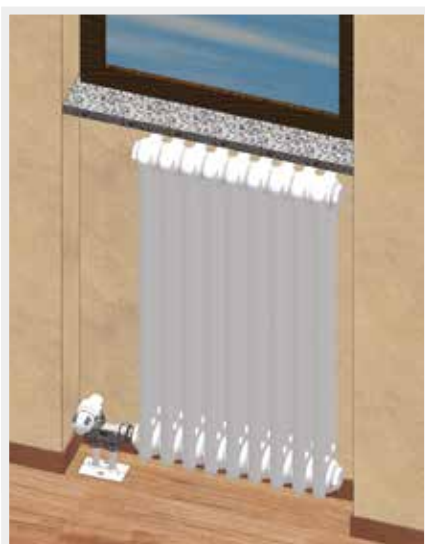
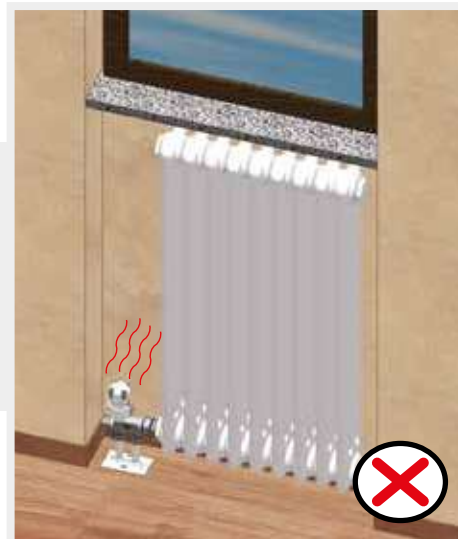

For a better regulation it is possible to install on the valve the thermostatic head with angled swiveling adapter (art.1834), which allows to direct the temperature sensor in order to improve the sensitivity. This adapter can be installed on any FAR thermostatic valve.

In case of any obstacles near the radiator (like curtains or other furnishing elements) it is necessary to install a thermostatic head with remote sensor (art.1800) in order to have a correct temperature detection and consequently an effective regulation.

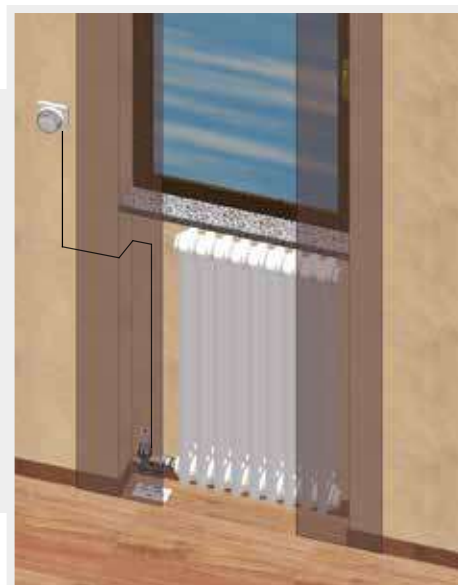



Chrome-plated angled manual radiator valve.

- interchangeable sizes for copper, plastic and multilayer pipe
- arm with sealing O-ring and stuffing box
- metallic sealing lock and O-ring seal
- terminal provided with EPDM gasket

## ART. 1055 **S2012**

Code	size	€	box	pack
1055 38	3/8"		10	50
1055 12	1/2"		10	50



Chrome-plated angled lockshield valve.

- interchangeable sizes for copper, plastic and multilayer pipe
- plastic covering cap
- sealing O-ring on the arm
- metallic sealing lock and O-ring seal
- terminal provided with EPDM gasket

## ART. 1105 **S2012**

Code	size	€	box	pack
1105 38	3/8"		10	50
1105 12	1/2"		10	50



Chrome-plated straight manual radiator valve.

- interchangeable sizes for copper, plastic and multilayer pipe
- arm with sealing O-ring and stuffing box
- metallic sealing lock and O-ring seal
- terminal provided with EPDM gasket

## ART. 1255 **S2012**

Code	size	€	box	pack
1255 38	3/8"		10	50
1255 12	1/2"		10	50



Chrome-plated straight lockshield valve.

- interchangeable sizes for copper, plastic and multilayer pipe
- plastic covering cap
- sealing O-ring on the arm
- metallic sealing lock and O-ring seal
- terminal provided with EPDM gasket

## ART. 1305 **S2012**

Code	size	€	box	pack
1305 38	3/8"		10	50
1305 12	1/2"		10	50



Chrome-plated angled manual radiator valve.

- iron pipe connection
- arm with sealing O-ring and stuffing box
- metallic sealing lock and O-ring seal
- terminal provided with EPDM gasket

## ART. 1155 **S2012**

Code	size	€	box	pack
1155 38	3/8"		10	50
1155 12	1/2"		10	50



Chrome-plated angled lockshield valve.

- iron pipe connection
- plastic covering cap
- sealing O-ring on the arm
- metallic sealing lock and O-ring seal
- terminal provided with EPDM gasket

## ART. 1215 **S2012**

Code	size	€	box	pack
1215 38	3/8"		10	50
1215 12	1/2"		10	50
1215 34	3/4"		5	50



Chrome-plated straight manual radiator valve.

- iron pipe connection
- arm with sealing O-ring and stuffing box
- metallic sealing lock and O-ring seal
- terminal provided with EPDM gasket

## ART. 1355 **S2012**

Code	size	€	box	pack
1355 38	3/8"		10	50
1355 12	1/2"		10	50



Chrome-plated straight lockshield valve.

- iron pipe connection
- plastic covering cap
- sealing O-ring on the arm
- metallic sealing lock and O-ring seal
- terminal provided with EPDM gasket

## ART. 1415 **S2012**

Code	size	€	box	pack
1415 38	3/8"		10	50
1415 12	1/2"		10	50
1415 34	3/4"		5	50



Chrome-plated angled manual radiator valve.

- interchangeable sizes for copper, plastic and multilayer pipe
- handle with reinforced metal insert
- arm with double seal, O-ring and stuffing box
- metallic sealing lock and O-ring seal
- terminal provided with Loctite® Dri-Seal® 5061

**ART. 1050**

Code	size	€	box	pack
1050 38	3/8"		10	50
1050 12	1/2"		10	50



Chrome-plated angled lockshield valve.

- interchangeable sizes for copper, plastic and multilayer pipe
- brass covering cap
- double sealing O-ring on the arm
- metallic sealing lock and O-ring seal
- terminal provided with Loctite® Dri-Seal® 5061

**ART. 1100**

Code	size	€	box	pack
1100 38	3/8"		10	50
1100 12	1/2"		10	50



Chrome-plated straight manual radiator valve.

- interchangeable sizes for copper, plastic and multilayer pipe
- handle with reinforced metal insert
- arm with double seal, O-ring and stuffing box
- metallic sealing lock and O-ring seal
- terminal provided with Loctite® Dri-Seal® 5061

**ART. 1250**

Code	size	€	box	pack
1250 38	3/8"		10	50
1250 12	1/2"		10	50



Chrome-plated straight lockshield valve.

- interchangeable sizes for copper, plastic and multilayer pipe
- brass covering cap
- double sealing O-ring on the arm
- metallic sealing lock and O-ring seal
- terminal provided with Loctite® Dri-Seal® 5061

**ART. 1300**

Code	size	€	box	pack
1300 38	3/8"		10	50
1300 12	1/2"		10	50



Chrome-plated angled manual radiator valve.

- iron pipe connection
- handle with reinforced metal insert
- arm with double seal, O-ring and stuffing box
- metallic sealing lock and O-ring seal
- terminal provided with Loctite® Dri-Seal® 5061

**ART. 1150**

Code	size	€	box	pack
1150 38	3/8"		10	50
1150 12	1/2"		10	50
1150 34	3/4"		5	50
1150 1	1"		5	40



Chrome-plated angled lockshield valve.

- iron pipe connection
- brass covering cap
- double sealing O-ring on the arm
- metallic sealing lock and O-ring seal
- terminal provided with Loctite® Dri-Seal® 5061

**ART. 1200**

Code	size	€	box	pack
1200 38	3/8"		10	50
1200 12	1/2"		10	50
1200 34	3/4"		5	50
1200 1	1"		5	40



Chrome-plated straight manual radiator valve.

- iron pipe connection
- handle with reinforced metal insert
- arm with double seal, O-ring and stuffing box
- metallic sealing lock and O-ring seal
- terminal provided with Loctite® Dri-Seal® 5061

**ART. 1350**

Code	size	€	box	pack
1350 38	3/8"		10	50
1350 12	1/2"		10	50
1350 34	3/4"		5	50
1350 1	1"		5	40



Chrome-plated straight lockshield valve.

- iron pipe connection
- brass covering cap
- double sealing O-ring on the arm
- metallic sealing lock and O-ring seal
- terminal provided with Loctite® Dri-Seal® 5061

**ART. 1400**

Code	size	€	box	pack
1400 38	3/8"		10	50
1400 12	1/2"		10	50
1400 34	3/4"		5	50
1400 1	1"		5	40



Chrome-plated angled manual radiator valve.

- interchangeable sizes for copper, plastic and multilayer pipe
- handle with reinforced metal insert
- arm with double seal, O-ring and stuffing box
- metallic sealing lock and O-ring seal
- terminal provided with EPDM gasket

## ART. 1051



Code	size	€	box	pack
1051 38	3/8"		10	50
1051 12	1/2"		10	50

Chrome-plated angled lockshield valve.

- interchangeable sizes for copper, plastic and multilayer pipe
- brass covering cap
- double sealing O-ring on the arm
- metallic sealing lock and O-ring seal
- terminal provided with EPDM gasket



## ART. 1111



Code	size	€	box	pack
1111 38	3/8"		10	50
1111 12	1/2"		10	50

Chrome-plated straight manual radiator valve.

- interchangeable sizes for copper, plastic and multilayer pipe
- handle with reinforced metal insert
- arm with double seal, O-ring and stuffing box
- metallic sealing lock and O-ring seal
- terminal provided with EPDM gasket

## ART. 1251



Code	size	€	box	pack
1251 38	3/8"		10	50
1251 12	1/2"		10	50

Chrome-plated straight lockshield valve.

- interchangeable sizes for copper, plastic and multilayer pipe
- brass covering cap
- double sealing O-ring on the arm
- metallic sealing lock and O-ring seal
- terminal provided with EPDM gasket



## ART. 1311



Code	size	€	box	pack
1311 38	3/8"		10	50
1311 12	1/2"		10	50

Chrome-plated angled manual radiator valve.

- iron pipe connection
- handle with reinforced metal insert
- arm with double seal, O-ring and stuffing box
- metallic sealing lock and O-ring seal
- terminal provided with EPDM gasket

## ART. 1151



Code	size	€	box	pack
1151 38	3/8"		10	50
1151 12	1/2"		10	50

Chrome-plated angled lockshield valve.

- iron pipe connection
- brass covering cap
- double sealing O-ring on the arm
- metallic sealing lock and O-ring seal
- terminal provided with EPDM gasket



## ART. 1211



Code	size	€	box	pack
1211 38	3/8"		10	50
1211 12	1/2"		10	50

Chrome-plated straight manual radiator valve.

- iron pipe connection
- handle with reinforced metal insert
- arm with double seal, O-ring and stuffing box
- metallic sealing lock and O-ring seal
- terminal provided with EPDM gasket

## ART. 1351



Code	size	€	box	pack
1351 38	3/8"		10	50
1351 12	1/2"		10	50

Chrome-plated straight lockshield valve.

- iron pipe connection
- brass covering cap
- double sealing O-ring on the arm
- metallic sealing lock and O-ring seal
- terminal provided with EPDM gasket



## ART. 1411



Code	size	€	box	pack
1411 38	3/8"		10	50
1411 12	1/2"		10	50

Chrome-plated thermostatic SINGLE/DOUBLE PIPE angled valve.

- connections: 3/4" EUROKONUS
- for radiators with 3/4" male connection
- centre distance between ports: 50 mm
- flat gaskets in EPDM

**ART. 1485**

Code	outlets	€	box	pack
1485	3/4" EUROKONUS		5	50

Chrome-plated thermostatic SINGLE/DOUBLE PIPE straight valve.

- connections: 3/4" EUROKONUS
- for radiators with 3/4" male connection
- centre distance between ports: 50 mm
- flat gaskets in EPDM

**ART. 1489**

Code	outlets	€	box	pack
1489	3/4" EUROKONUS		5	50

Chrome-plated thermostatic SINGLE/DOUBLE PIPE angled valve.

- connections: FAR 24 x 19
- for radiators with 3/4" male connection
- centre distance between ports: 50 mm
- flat gaskets in EPDM

**ART. 1486**

Code	outlets	€	box	pack
1486	24 x 19		5	50

Chrome-plated thermostatic SINGLE/DOUBLE PIPE straight valve.

- connections: FAR 24 x 19
- for radiators with 3/4" male connection
- centre distance between ports: 50 mm
- flat gaskets in EPDM

**ART. 1490**

Code	outlets	€	box	pack
1490	24 x 19		5	50

Chrome-plated thermostatic SINGLE/DOUBLE PIPE angled valve.

- connections: 3/4" EUROKONUS
- for radiators with 1/2" female connection
- centre distance between ports: 50 mm
- terminal provided with EPDM gasket

**ART. 1487**

Code	outlets	€	box	pack
1487	3/4" EUROKONUS		5	50

Chrome-plated thermostatic SINGLE/DOUBLE PIPE straight valve.

- connections: 3/4" EUROKONUS
- for radiators with 1/2" female connection
- centre distance between ports: 50 mm
- terminal provided with EPDM gasket

**ART. 1491**

Code	outlets	€	box	pack
1491	3/4" EUROKONUS		5	50

Chrome-plated thermostatic SINGLE/DOUBLE PIPE angled valve.

- connections: FAR 24 x 19
- for radiators with 1/2" female connection
- centre distance between ports: 50 mm
- terminal provided with EPDM gasket

**ART. 1488**

Code	outlets	€	box	pack
1488	24 x 19		5	50

Chrome-plated thermostatic SINGLE/DOUBLE PIPE straight valve.

- connections: FAR 24 x 19
- for radiators with 1/2" female connection
- centre distance between ports: 50 mm
- terminal provided with EPDM gasket

**ART. 1492**

Code	outlets	€	box	pack
1492	24 x 19		5	50

Chrome-plated thermostatic SINGLE/DOUBLE PIPE angled valve for panel radiators.

- adjustable by-pass
- connections: 3/4" EUROKONUS
- centre distance between ports: 50 mm
- Flat gaskets in EPDM

**ART. 1481**

Code	outlets	€	box	pack
1481	3/4" EUROKONUS		5	50

Chrome-plated thermostatic SINGLE/DOUBLE PIPE angled valve for panel radiators.

- adjustable by-pass
- connections: FAR 24 X 19
- centre distance between ports: 50 mm
- Flat gaskets in EPDM

**ART. 1482**

Code	outlets	€	box	pack
1482	24 x 19		5	50

Chrome-plated thermostatic SINGLE/DOUBLE PIPE straight valve for panel radiators.

- adjustable by-pass
- connections: 3/4" EUROKONUS
- centre distance between ports: 50 mm
- Flat gaskets in EPDM

**ART. 1483**

Code	outlets	€	box	pack
1483	3/4" EUROKONUS		5	50

Chrome-plated thermostatic SINGLE/DOUBLE PIPE straight valve for panel radiators.

- adjustable by-pass
- connections: FAR 24 X 19
- centre distance between ports: 50 mm
- Flat gaskets in EPDM

**ART. 1484**

Code	outlets	€	box	pack
1484	24 x 19		5	50

Sealing KIT complete with 2 adapters for ART. 1421-1422-1423-1424-1481-1482-1483-1484 for panel radiators with 3/4" male connection.

**ART. 6080**

Code	€	box
6080		25

Sealing KIT complete with 2 adapters for ART. 1421-1422-1423-1424-1481-1482-1483-1484 for panel radiators with 1/2" female connection.

**ART. 6081**

Code	€	box
6081		25

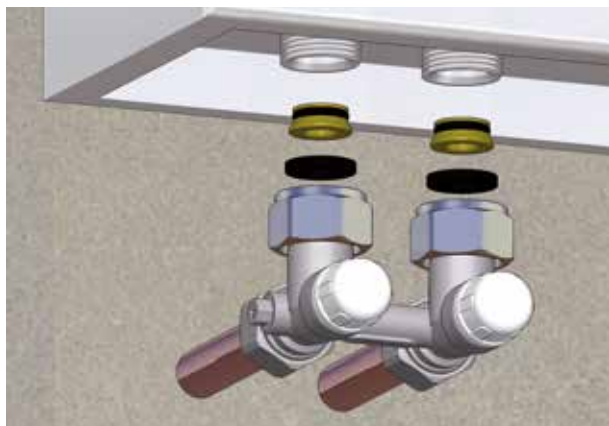

Connection to panel radiator with 3/4" male EUROKONUS by means of adapters art. 6080.

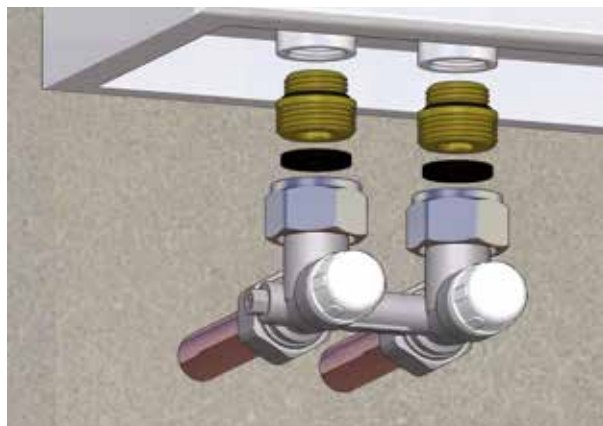

Connection to panel radiator with 1/2" female by means of adapters art. 6081.



Chrome-plated thermostatic SINGLE/DOUBLE PIPE straight valve without union and nut.

- interchangeable sizes for copper, plastic and multilayer pipe
- central connection to the heating body
- centre distance between ports: 35 mm

**ART. 1431**

Code € box pack

1431		10	40
------	--	----	----

Chrome-plated thermostatic SINGLE/DOUBLE PIPE angled valve, right-hand version. Without union and nut.

- interchangeable sizes for copper, plastic and multilayer pipe
- central connection to the heating body
- centre distance between ports: 35 mm

**ART. 1432**

Code € box pack

1432		10	40
------	--	----	----

Chrome-plated thermostatic SINGLE/DOUBLE PIPE angled valve, left-hand version. Without union and nut.

- interchangeable sizes for copper, plastic and multilayer pipe
- central connection to the heating body
- centre distance between ports: 35 mm

**ART. 1433**

Code € box pack

1433		10	40
------	--	----	----

Chrome-plated thermostatic SINGLE/DOUBLE PIPE valve.

- interchangeable sizes for copper, plastic and multilayer pipe
- 450 mm Ø 12 mm metal probe
- centre distance between ports: 35 mm

D = RIGHT connection

S = LEFT connection

**ART. 1438**

Code size € box pack

1438 12	1/2"		5	40
1438 34	3/4"		5	40
1438 1D	1"		5	40
1438 1S	1"		5	40

Chrome-plated thermostatic SINGLE/DOUBLE PIPE straight valve complete with union and nut.

- 450 mm Ø 10 mm metal probe
- interchangeable sizes for copper, plastic and multilayer pipe
- central connection to the heating body
- centre distance between ports: 35 mm

**ART. 1435**

Code probe size € box pack

1435	Ø 10	1/2"		10	40
------	------	------	--	----	----

Chrome-plated thermostatic SINGLE/DOUBLE PIPE angled valve, right-hand version. Complete with union and nut.

- 450 mm Ø 10 mm metal probe
- interchangeable sizes for copper, plastic and multilayer pipe
- central connection to the heating body
- centre distance between ports: 35 mm

**ART. 1436**

Code probe size € box pack

1436	Ø 10	1/2"		10	40
------	------	------	--	----	----

Chrome-plated thermostatic SINGLE/DOUBLE PIPE angled valve, left-hand version. Complete with union and nut

- 450 mm Ø 10 mm metal probe
- interchangeable sizes for copper, plastic and multilayer pipe
- central connection to the heating body
- centre distance between ports: 35 mm

**ART. 1437**

Code probe size € box pack

1437	Ø 10	1/2"		10	40
------	------	------	--	----	----

# 7 THERMOSTATIC SINGLE/DOUBLE PIPE VALVES



Chrome-plated straight thermostatic SINGLE-PIPE valve **with adjustable centre distance**.

- interchangeable sizes for copper, plastic and multilayer pipe
- 450 mm Ø 12 mm metal probe
- centre distance between ports: 40-50 mm and 48-65 mm
- **Patent pending**

D = RIGHT connection  
S = LEFT connection



## ART. 1425

Code	probe	size	centre dist.	€	box	pack
1425 1250	Ø 12	1/2"	40-50 mm		1	40
1425 1265	Ø 12	1/2"	48-65 mm		1	40
1425 3450	Ø 12	3/4"	40-50 mm		1	40
1425 3465	Ø 12	3/4"	48-65 mm		1	40
1425 150D	Ø 12	1"	40-50 mm		1	40
1425 150S	Ø 12	1"	40-50 mm		1	40
1425 165D	Ø 12	1"	48-65 mm		1	40
1425 165S	Ø 12	1"	48-65 mm		1	40

Single-double pipe thermostatic valves, Art.1425-1428, allow the distance between the flow and the return connections to be changed, depending on your system requirements

This type of valve provides manual or thermostatic regulation.

Chrome-plated angled thermostatic SINGLE-PIPE valve **with adjustable centre distance**.

- interchangeable sizes for copper, plastic and multilayer pipe
- 450 mm Ø 12 mm metal probe
- centre distance between ports: 40-50 mm and 48-65 mm
- **Patent pending**

D = RIGHT connection  
S = LEFT connection



## ART. 1428

Code	probe	size	centre dist.	€	box	pack
1428 1250	Ø 12	1/2"	40-50 mm		1	-
1428 1265	Ø 12	1/2"	48-65 mm		1	-
1428 3450	Ø 12	3/4"	40-50 mm		1	-
1428 3465	Ø 12	3/4"	48-65 mm		1	-
1428 150D	Ø 12	1"	40-50 mm		1	-
1428 150S	Ø 12	1"	40-50 mm		1	-
1428 165D	Ø 12	1"	48-65 mm		1	-
1428 165S	Ø 12	1"	48-65 mm		1	-

In order to change the distance between the flow and return, the regulating curve should be lengthened until it reaches the desired position. **There are two adjustment ranges: 40mm - 50mm or 48mm - 65mm**

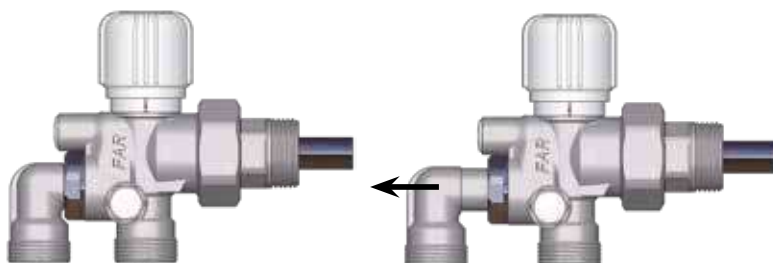

CODE	SIZE	CENTRE DISTANCE	
		MIN	MAX
1425 1250 - 1428 1250	1/2"	40mm	50mm
1425 1265 - 1428 1265	1/2"	48mm	65mm
1425 3450 - 1428 3450	3/4"	40mm	50mm
1425 3465 - 1428 3465	3/4"	48mm	65mm
1425 150D* - 1428 150D*	1"	40mm	50mm
1425 150S* - 1428 150S*	1"	40mm	50mm
1425 165D* - 1428 165D*	1"	48mm	65mm
1425 165S* - 1428 165S*	1"	48mm	65mm

\* D: right thread S: left thread

In order to change the configuration from single-pipe to double-pipe and vice versa, remove the white cap as shown in the figure and turn the by-pass screw with the aid of a screwdriver or an Allen key.

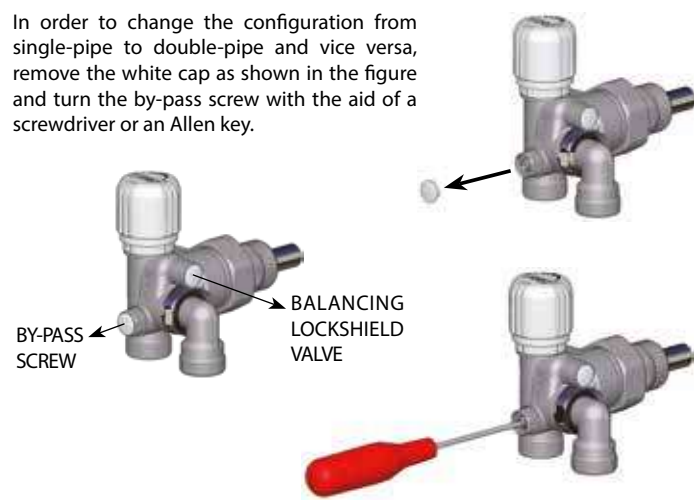

**Installation example of thermostatic single/double-pipe valves with adjustable centre distance**



Chrome-plated thermostatic SINGLE-PIPE valve.

- interchangeable sizes for copper, plastic and multilayer pipe
- 450 mm Ø 12 mm metal probe
- centre distance between ports: 35 mm

D = RIGHT connection

S = LEFT connection



## ART. 1420



Code	probe	size	€	box	pack
1420 12	Ø 12	1/2"		5	20
1420 34	Ø 12	3/4"		5	20
1420 1D	Ø 12	1"		5	20
1420 1S	Ø 12	1"		5	20

Chrome-plated thermostatic SINGLE-PIPE "GRT" valve.

- interchangeable sizes for copper, plastic and multilayer pipe
- connection for external probe
- input for heating fluid from above
- centre distance between ports: 35 mm

NB the connection probe must be purchased separately.



## ART. 1440



Code	size	€	box	pack
1440 12	1/2"		5	40

Chrome-plated thermostatic SINGLE-PIPE valve.

- interchangeable sizes for copper, plastic and multilayer pipe
- reversible union for external probe
- input for heating fluid from above
- centre distance between ports: 35 mm

NB the connection probe must be purchased separately.



## ART. 1442



Code	size	€	box	pack
1442 12	1/2"		5	-

Chrome-plated thermostatic DOUBLE-PIPE valve.

- interchangeable sizes for copper, plastic and multilayer pipe
- 450 mm Ø 12 mm metal probe
- centre distance between ports: 35 mm

D = RIGHT connection

S = LEFT connection



### ART. 1430



Code	probe	size	€	box	pack
1430 12	Ø 12	1/2"		5	20
1430 34	Ø 12	3/4"		5	20
1430 1D	Ø 12	1"		5	20
1430 1S	Ø 12	1"		5	20

Chrome-plated thermostatic DOUBLE-PIPE valve for external probe.

- interchangeable sizes for copper, plastic and multilayer pipe
- External probe connection
- input for heating fluid from above
- centre distance between ports: 35 mm
- Radiator connections: 1/2"

NB the connection probe must be purchased separately.



### ART. 1457



Code	size	€	box	pack
1457 12	1/2"		5	40

## INSTALLATION

The circuit is characterized by having a supply and a return pipe for each radiator.

The example shows a circuit with three radiators with valves Art.1457 and distribution manifolds in box for supply and return.

### Installation overview

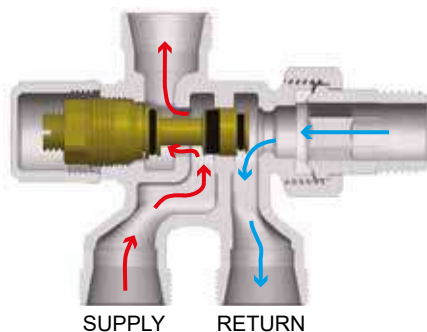
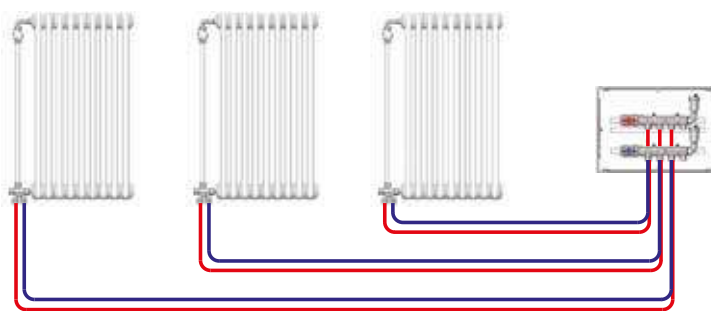

SUPPLY RETURN

The lockshield valve calibration, by means of a 5 Allen wrench or a screwdriver, allows the water flow to the radiator to be adjusted. The picture shows flow with valve open. By closing the lockshield valve there is no water passing inside the radiator.

Handle for opening and closing of water flow to radiator  
(Possibility of installing the thermostatic control Art.1824)

Lockshield valve for circuit balancing



Chrome-plated manual MONOSTILE valve for single-pipe systems.

- interchangeable sizes for copper, plastic and multilayer pipe
- 450 mm Ø 12 mm metal probe
- centre distance between ports: 35 mm

D = RIGHT connection  
S = LEFT connection



### ART. 1450

Code	probe	size	€	box	pack
1450 1212	Ø 12	1/2"		5	20
1450 3412	Ø 12	3/4"		5	20
1450 3414	Ø 14	3/4"		5	20
1450 114D	Ø 14	1"		5	20
1450 114S	Ø 14	1"		5	20

Chrome-plated manual MONOTUBO valve for single-pipe systems.

- interchangeable sizes for copper, plastic and multilayer pipe
- 450 mm Ø 12 mm metal probe
- centre distance between ports: 35 mm



### ART. 1455

Code	probe	size	€	box	pack
1455 1212	Ø 12	1/2"		5	50
1455 3412	Ø 12	3/4"		5	50

Chrome-plated manual MONOFAR valve for single-pipe systems.

- interchangeable sizes for copper, plastic and multilayer pipe
- 450 mm Ø 12 mm metal probe
- centre distance between ports: 35 mm



### ART. 1451

Code	probe	size	€	box	pack
1451 1212	Ø 12	1/2"		5	50
1451 3412	Ø 12	3/4"		5	50

Chrome-plated manual MONOSTILE valve for single-pipe systems.

- interchangeable sizes for copper, plastic and multilayer pipe
- bent probe for panel radiators
- centre distance between ports: 35 mm

### ART. 8050

- Single-panel bent probe.



### ART. 8051

- Double-panel bent probe.



Chrome-plated manual BITUBO valve for double-pipe systems.

- interchangeable sizes for copper, plastic and multilayer pipe
- 450 mm Ø 12 mm metal probe
- centre distance between ports: 35 mm



### ART. 1456

Code	size	€	box	pack
1456 1212	1/2"		5	50

Chrome-plated manual MONOTUBO valve for convector.

- interchangeable sizes for copper, plastic and multilayer pipe
- input for heating fluid from above
- centre distance between ports: 35 mm

NB the connection probe must be purchased separately.



### ART. 1600

Code	size	€	box	pack
1600 12	1/2"		3	24

Chrome-plated manual MONODET valve for single-pipe systems.

- interchangeable sizes for copper, plastic and multilayer pipe
- 450 mm Ø 12 mm metal probe
- centre distance between ports: 35 mm
- **While stocks last**

D = RIGHT connection  
S = LEFT connection



### ART. 1550

Code	probe	size	€	box	pack
1550 1212	Ø 12	1/2"		10	20
1550 3412	Ø 12	3/4"		10	20
1550 3414	Ø 14	3/4"		10	20
1550 114D	Ø 14	1"		10	20
1550 114S	Ø 14	1"		10	20



Chrome-plated manual MONOSTILE valve for single-pipe systems.

- reversible union for external probe
- interchangeable sizes for copper, plastic and multilayer pipe
- centre distance between ports: 35 mm

**ART. 1462**

Code	size	€	box	pack
1462 12	1/2"		5	40

Chrome-plated manual MONOSTILE valve for single-pipe systems.

- reversible union for external probe
- chrome-plated male elbow
- interchangeable sizes for copper, plastic and multilayer pipe
- centre distance between ports: 35 mm

NB the connection probe must be purchased separately.

**ART. 1472**

Code	size	€	box	pack
1472 12	1/2"		5	40

Chrome-plated manual MONOFAR valve for single-pipe systems.

- reversible union for external probe
- chrome-plated male elbow
- interchangeable sizes for copper, plastic and multilayer pipe
- centre distance between ports: 35 mm

NB the connection probe must be purchased separately.

**ART. 1452**

Code	size	€	box	pack
1452 12	1/2"		5	40

Chrome-plated manual valve for single-pipe systems.

- reversible union for external probe
- interchangeable sizes for copper, plastic and multilayer pipe
- centre distance between ports: 35 mm

**ART. 1463**

Code	size	€	box	pack
1463 12	1/2"		5	40

Chrome-plated manual valve for single-pipe systems.

- reversible union for external probe
- chrome-plated male elbow
- interchangeable sizes for copper, plastic and multilayer pipe
- centre distance between ports: 35 mm

NB the connection probe must be purchased separately.

**ART. 1473**

Code	size	€	box	pack
1473 12	1/2"		5	40

Chrome-plated reversible union for MONOSTILE valve ART.1462-1472, with connection for external probe.

**ART. 8335**

Code	size	€	box
8335 12	1/2"		10

Chrome-plated reduced reversible union for MONOTUBO valve ART.1452-1463-1473, with connection for external probe.

**ART. 8336**

Code	size	€	box
8336 12	1/2"		10

Chrome-plated manual GRD valve for single-pipe systems.

- interchangeable sizes for copper, plastic and multilayer pipe
- external probe connection
- input for heating fluid from above
- preset for connection to ART. 1630
- centre distance between ports: 35 mm

NB the connection probe must be purchased separately.

**ART. 1575**

Code	size	€	box	pack
1575 12	1/2"		5	40

Chrome-plated manual GR valve for single-pipe systems.

- interchangeable sizes for copper, plastic and multilayer pipe
- external probe connection
- input for heating fluid from above
- centre distance between ports: 35 mm

NB the connection probe must be purchased separately.

**ART. 1585**

Code	size	€	box	pack
1585 12	1/2"		5	40

Chrome-plated manual GR 3P valve for single-pipe systems.

- interchangeable sizes for copper, plastic and multilayer pipe
- external probe connection
- input for heating fluid from above
- centre distance between ports: 35 mm

NB the connection probe must be purchased separately.

**ART. 1590**

Code	size	€	box	pack
1590 12	1/2"		5	40

Chrome-plated manual GRM valve for single-pipe systems.

- interchangeable sizes for copper, plastic and multilayer pipe
- external probe connection
- input for heating fluid from above
- centre distance between ports: 35 mm

NB the connection probe must be purchased separately.

**ART. 1595**

Code	size	€	box	pack
1595 12	1/2"		5	40

Chrome-plated elbow for GR valve (art. 1585).

**ART. 5226**

Code	size	€	box	pack
5226	1/2"		25	-

Chrome-plated elbow for GRD valve (art. 1575).

**ART. 5227**

Code	size	€	box	pack
5227	1/2"		25	-

Chrome-plated elbow for GR 3P valve (art. 1590).

**ART. 5229**

Code	size	€	box	pack
5229	1/2"		25	-

Chrome-plated elbow for installation of art. 1630 on GRM valve (art. 1595).

**ART. 5232**

Code	size	€	box	pack
5232	1/2"		25	-

# 7 SINGLE/DOUBLE MANUAL PIPE VALVES

Chrome-plated manual SINGLE/DOUBLE PIPE angled valve for panel radiators.

- adjustable by-pass
- connections: 3/4" EUROKONUS
- centre distance between ports: 50 mm
- Flat gaskets in EPDM



## ART. 1421



Code	outlets	€	box	pack
1421	3/4" EUROKONUS		5	50

Chrome-plated manual SINGLE/DOUBLE PIPE straight valve for panel radiators.

- adjustable by-pass
- connections: 3/4" EUROKONUS
- centre distance between ports: 50 mm
- Flat gaskets in EPDM



## ART. 1423



3/4" EUROKONUS CONNECTION

Code	outlets	€	box	pack
1423	3/4" EUROKONUS		5	50

Sealing KIT complete with 2 adapters for ART. 1421-1422-1423-1424-1481-1482-1483-1484 for panel radiators with 3/4" male connection.

## ART. 6080



Code	€	box
6080		25

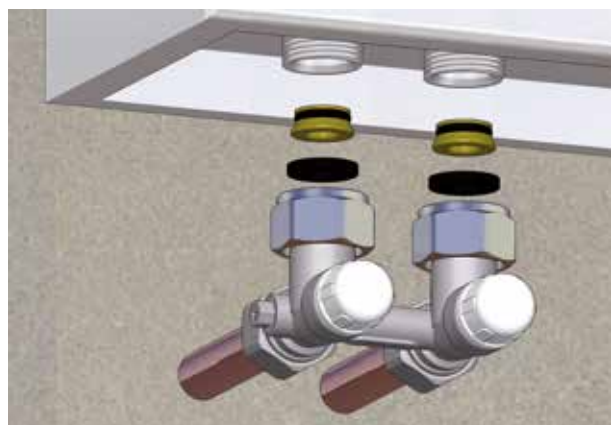

Connection to panel radiator with 3/4" male EUROKONUS by means of adapters art. 6080.

Chrome-plated manual SINGLE/DOUBLE PIPE angled valve for panel radiators.

- adjustable by-pass
- connections: FAR 24 X 19
- centre distance between ports: 50 mm
- Flat gaskets in EPDM



## ART. 1422



Code	outlets	€	box	pack
1422	24 x 19		5	50

Chrome-plated manual SINGLE/DOUBLE PIPE straight valve for panel radiators.

- adjustable by-pass
- connections: FAR 24 X 19
- centre distance between ports: 50 mm
- Flat gaskets in EPDM



## ART. 1424



FAR 24X19 CONNECTION

Code	outlets	€	box	pack
1424	24 x 19		5	50

Sealing KIT complete with 2 adapters for ART. 1421-1422-1423-1424-1481-1482-1483-1484 for panel radiators with 1/2" female connection.



## ART. 6081

Code	€	box
6081		25

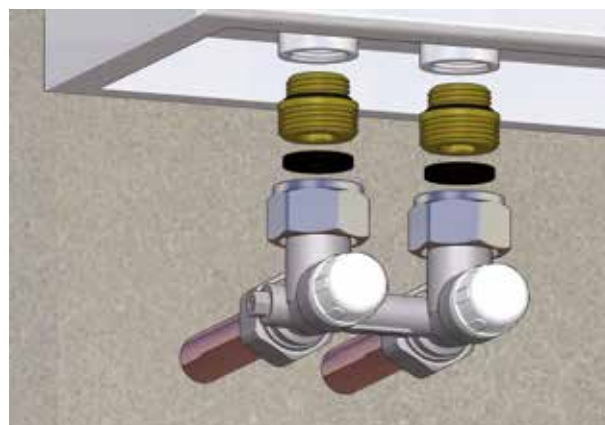

Connection to panel radiator with 1/2" female by means of adapters art. 6081.

Chrome-plated eccentric fitting for connection in case of heating body replacement, with variation of centre distance between ports.

- connections: FEMALE-MALE



## ART. 5560

Code	centre dist.	size	€	box	pack
5560 138	cm. 1	3/8"x3/8"		25	250
5560 238	cm. 2	3/8"x3/8"		25	250
5560 338	cm. 3	3/8"x3/8"		25	250
5560 438	cm. 4	3/8"x3/8"		25	250
5560 538	cm. 5	3/8"x3/8"		25	250
5560 638	cm. 6	3/8"x3/8"		25	250

Code	centre dist.	size	€	box	pack
5560 112	cm. 1	1/2"x1/2"		25	250
5560 212	cm. 2	1/2"x1/2"		25	250
5560 312	cm. 3	1/2"x1/2"		25	250
5560 412	cm. 4	1/2"x1/2"		25	250
5560 512	cm. 5	1/2"x1/2"		25	250
5560 612	cm. 6	1/2"x1/2"		25	250
5560 134	cm. 1	3/4"x3/4"		10	300
5560 234	cm. 2	3/4"x3/4"		10	300
5560 334	cm. 3	3/4"x3/4"		10	160
5560 434	cm. 4	3/4"x3/4"		10	160
5560 534	cm. 5	3/4"x3/4"		10	160
5560 634	cm. 6	3/4"x3/4"		10	100

Chrome-plated eccentric fitting for connection in case of heating body replacement, with variation of centre distance between ports.

- connections: MALE-MALE



## ART. 5563

Code	centre dist.	size	€	box	pack
5563 13412	cm. 1	3/4"x1/2"		25	250
5563 23412	cm. 2	3/4"x1/2"		25	250
5563 33412	cm. 3	3/4"x1/2"		25	250
5563 43412	cm. 4	3/4"x1/2"		25	250
5563 53412	cm. 5	3/4"x1/2"		25	250
5563 63412	cm. 6	3/4"x1/2"		25	250

Brass plug for plant test.



## ART. 1444



Code	€	box	pack
1444		50	-

Brass plug for plant test.

- Ø 22mm copper pipe



## ART. 1446

Code	€	box	pack
1446 22		50	-

Brass external template without nuts for testing of SINGLE/DOUBLE PIPE systems.

- centre distance between ports: 35 mm



## ART. 1445



Code	€	box	pack
1445		50	-

Fitting suitable for connection of a FAR 1/2" manual or thermostatic valve to a fancoil with 3/4" male eurokonus connection.

- M26x1.5 nut
- 3/4" nut
- O-Ring in EPDM-P
- CW617N printed brass

NB. On request available with valve



## ART. 8328

Code	size	€	box
8328 34	3/4"		1

Chrome-plated telescopic terminal.

- size: 3/8" - extension from 32mm to 55mm
- size: 1/2" - 3/4" - extension from 35mm to 60mm



## ART. 8820

Code	size	€	box	pack
8820 38	3/8" 32-55 mm		10	-
8820 12	1/2" 35-60 mm		10	-
8820 34	3/4" 35-60 mm		10	-

Chrome-plated copper pipe complete with threaded fitting

- 1/2" male connection with EDPM gasket
- Copper pipe: D. 15 mm



## ART. 8875

Code	length	size	€	box	pack
8875 1210	100 mm	1/2"		20	-
8875 1220	200 mm	1/2"		20	-

Chrome-plated fitting, to change a 1/2" iron pipe connection to a Ø 15mm connection for copper pipe.

- Connection: 1/2" female
- Copper pipe: Ø 15 mm
- Length: 50 mm



## ART. 8876

Code	length	size	€	box	pack
8876 1205	50 mm	1/2"		20	-

Plastic wall covering plate for valves and lockshield valves.

- Suitable for pipes from 10 to 20mm



## ART. 0441



Code	colour	finish	Ø	€	box	pack
0441 BL	white	glossy	10÷20		150	600

Available in different finishing, see page 230

Plastic wall covering plate for valves and lockshield valves.

## ART. 6200

Code	size	€	box	pack
6200 10	Ø 10		150	600
6200 12	Ø 12		150	600
6200 14	Ø 14		150	600
6200 16	Ø 16		150	600
6200 18	Ø 18		150	600
6200 22	Ø 22		150	600



Plastic wall covering plate for single-double pipe valves.

## ART. 6150

Code	size	€	box	pack
6150 12	Ø 12		100	400
6150 14	Ø 14		100	400
6150 16	Ø 16		100	400
6150 18	Ø 18		100	400





Chrome-plated reducer. Permits changing a FAR 24X19 male thread in a 1/2" - 3/4" male thread.

- sealing metal gasket with double O-ring
- suitable on FAR 24x19 male connections with Ø16 mm only

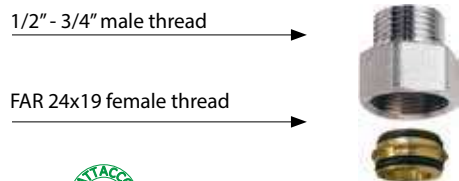
**ART. 8865**

Code	size	length/mm	€	box	pack
8865 3012	24x19 - 1/2" Flat faced	30		25	250
8865 3034	24x19 - 3/4" Flat faced	30		25	250
8865 3034EU	24x19 - 3/4" Eurokonus	30		25	250

Chrome-plated reducer. Permits changing a FAR 24X19 male thread in a 1/2" female thread.

- sealing metal gasket with double O-ring
- suitable on FAR 24x19 male connections with Ø16 mm only

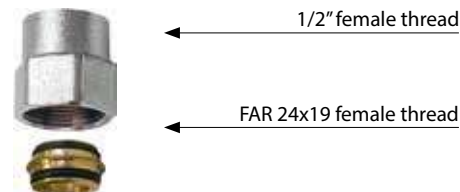
**ART. 8870**

Code	size	length/mm	€	box	pack
8870 30	24x19 - 1/2"	30		25	250

Chrome-plated straight extension.

- interchangeable sizes for copper, plastic and multilayer pipe
- sealing metal gasket with double O-ring
- suitable on FAR 24x19 male connections with Ø16 mm only

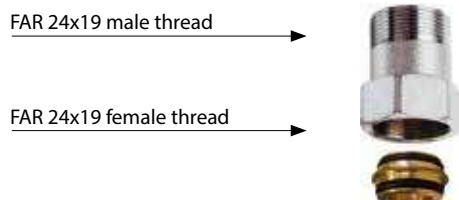
**ART. 8850**

Code	length/mm	€	box
8850 30	30		25
8850 35	35		25
8850 40	40		25

Chrome-plated straight extension. Permits changing a FAR 24 x 19 male thread in a Ø 18 connection for copper pipe.

- sealing metal gasket with double O-ring
- suitable on FAR 24x19 male connections with Ø16 mm only

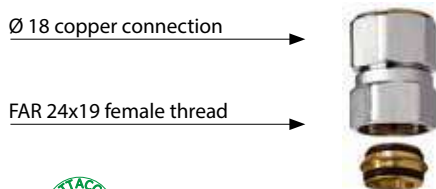
**ART. 8850**

Code	size	length/mm	€	box	pack
8850 G1830	24x19 - Ø18	30		25	250
8850 G1835	24x19 - Ø18	35		25	250
8850 G1840	24x19 - Ø18	40		25	250

Chrome-plated straight extension. Permits changing a FAR 24 x 19 male thread in a Ø 20-22 connection for copper pipe.

- sealing metal gasket with double O-ring
- suitable on FAR 24x19 male connections with Ø16 mm only

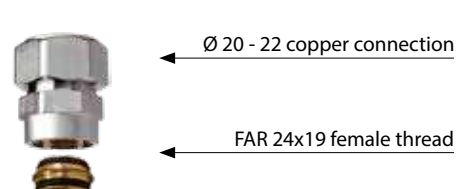
**ART. 8850**

Code	size	length/mm	€	box	pack
8850 G2030	24x19 - Ø 20	30		10	250
8850 G2230	24x19 - Ø 22	30		10	250

Chrome-plated special elbow.

- interchangeable sizes for copper, plastic and multilayer pipe
- Ø 16 mm cylindrical part

**ART. 8900**

Code	length/mm	€	box
8900 35	30		25
8900 100	100		25

Chrome-plated special elbow.

- interchangeable sizes for copper, plastic and multilayer pipe
- complete with chrome-plated manual air vent valve
- Ø 16 mm cylindrical part

**ART. 8901**

Code	€	box
8901		25

Body replacement kit for thermostatic valves, LadyFar and TopFar valves, art. 1428 excluded.

Complete with:

- wrench to replace bodies
- no. 10 Spare O-rings for extractor
- no. 20 bodies for thermostatic valves



## ART. 6002

Code	€	box	pack
6002		1	-

Insert for body replacement kit for thermostatic valves with presetting.

NB: to use this insert you need the body replacement kit for thermostatic valves, art.6002



## ART. 6003

Code	€	box	pack
6003		1	-

Brass body for thermostatic valves.



## ART. 9000

Code	€	box
9000		10

Brass body for thermostatic SINGLE/DOUBLE PIPE valves with adjustable centre distance between ports (ART. 1425).



## ART. 9009

Code	€	box
9009		10

Brass body for thermostatic valves with presetting.



## ART. 9006

Code	€	box
9006		10

Manual air vent valve.

- Plastic handle
- Sealing O-ring on the arm
- Gasket in PTFE for high temperature
- Nominal pressure: 10 bar
- Max. working temperature: 95°C

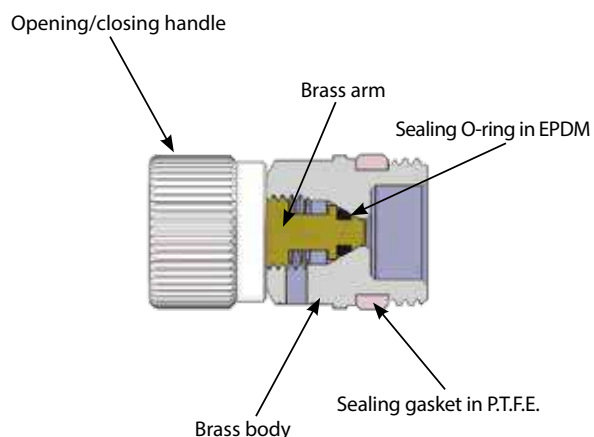

### ART. 6135

Code	size	€	box	pack
6135 18	1/8"		50	500
6135 14	1/4"		50	500
6135 38	3/8"		50	500
6135 12	1/2"		50	500

GAISER - Air vent valve with lateral purge.  
Supplied with gasket on the thread to make installation easier.

- Body made of CW617N stamped brass
- Nominal pressure: 10 bar
- Max. working differential pressure: 4 bar
- Max. working temperature: 110°C
- Float: PP



### ART. 2043

Code	finish	size	€	box	pack
2043 38	chrome	3/8"		10	100
2043 12	chrome	1/2"		10	100

Chrome-plated manual air vent valve with swiveling purge, hose and sealing O-Ring.

- Nominal pressure: 10 bar
- Max. working temperature: 80°C



### ART. 6015

Code	size	€	box	pack
6015 14	1/4"		50	500
6015 38	3/8"		50	500

Chrome-plated swiveling manual vent valve complete with square head and sealing O-Ring.

- Nominal pressure: 10 bar
- Max. working temperature: 80°C



### ART. 6010

Code	size	€	box
6010 12	1/2"		25

Key with square head for vent valves ART. 6010-6020.



### ART. 6300

Code	size	€	box
6300	□ 5		1

Chrome-plated manual air vent valve with swiveling purge. Opening handle with square head and sealing O-Ring.

- Nominal pressure: 10 bar
- Max. working temperature: 80°C



### ART. 6020

Code	size	€	box
6020 38	3/8"		40
6020 12	1/2"		40

Kit for plastic pipes. Suitable for all our products with 24x19 interchangeable connection.

Complete with:

- adapter for plastic pipe
- brass ring
- chrome-plated nut with 24x19 thread



### ART. 6052



Code	pipe	Ø external diameter	€	box	pack
6052 95147	plastic	10,5x1,25		50	250
6052 48186	plastic	12x2,15		50	250
6052 4847	plastic	12x2		50	250
6052 48184	plastic	12x1,5		50	250
6052 481005	plastic	12x1,35		50	250
6052 9761005	plastic	12,7x1,7		50	250
6052 976186	plastic	12,7x2,4		50	250
6052 6563	plastic	14x1,5		50	250
6052 6545	plastic	14x2		50	250
6052 4645	plastic	15x2,5		50	250
6052 4663	plastic	15x2		50	250
6052 46173	plastic	15x1,7		50	250
6052 4661	plastic	15x1,5		50	250
6052 5863	plastic	16x2,5		50	250
6052 58173	plastic	16x2,2		50	250
6052 5861	plastic	16x2		50	250
6052 58262	plastic	16x1,8		50	250
6052 5864	plastic	16x1,5		50	250
6052 58180	plastic	16x2,7		50	250
6052 15061	plastic	16,8x2,4		50	250
6052 150829	plastic	17x2,25		50	250
6052 15043	plastic	17x2		50	250
6052 6043	plastic	17,8x2,4		50	250
6052 60180	plastic	17,8x3,6		50	250
6052 4443	plastic	18x2,5		50	250
6052 44221	plastic	18x2,2		50	250
6052 4468	plastic	18x2		50	250
6052 8043	plastic	20x3,5		50	250
6052 8068	plastic	20x3		50	250
6052 80185	plastic	20x2,8		50	250
6052 80222	plastic	20x2,3		50	250
6052 8069	plastic	20x2,15		50	250
6052 80214	plastic	20x2		50	250
6052 80261	plastic	20x1,9		50	500

Kit for MULTILAYER pipes. Suitable for all our products with 24x19 interchangeable connection.

Complete with:

- adapter for plastic pipe
- brass ring
- chrome-plated nut with 24x19 thread



### ART. 6055



Code	pipe	Ø external diameter	€	box	pack
6055 902901	multilayer	11,6x1,5		50	250
6055 481156	multilayer	12x1,6		50	250
6055 48901	multilayer	12x1,8		50	250
6055 65193	multilayer	14x2		50	250
6055 46193	multilayer	15x2,5		50	250
6055 58190	multilayer	16x2		50	250
6055 58200	multilayer	16x2,25		50	250
6055 58278	multilayer	16,2x2,6		50	250
6055 150200	multilayer	16,8x2,5		50	250
6055 150810	multilayer	17x2		50	250
6055 44191	multilayer	18x2		50	250
6055 80204	multilayer	20x2		50	250
6055 80192	multilayer	20x2,25		50	250
6055 80201	multilayer	20x2,5		50	250
6055 80191	multilayer	20x2,9		50	250

Sealing compression KIT in rubber for copper pipe.

Complete with:

- brass pipe guide washer
- rubber compression single-taper
- brass ring
- chrome-plated nut 24x19 thread



### ART. 8427



Code	pipe	size	€	box	pack
8427 10	copper	Ø 10		100	500
8427 12	copper	Ø 12		100	500
8427 14	copper	Ø 14		100	500

Sealing compression KIT in rubber for copper pipe.

Complete with:

- rubber compression single-taper
- brass ring
- chrome-plated nut with 24x19 thread



### ART. 8429



Code	pipe	size	€	box	pack
8429 15	copper	Ø 15		100	500
8429 16	copper	Ø 16		100	500

Code	Description	size	gasket	€	box	pack
1610 38G18	ANGLED THERMOSTATIC VALVE	3/8"x18	Rubber		10	50
1610 12G18	ANGLED THERMOSTATIC VALVE	1/2"x18	Rubber		10	50
1630 38G18	STRAIGHT THERMOSTATIC VALVE	3/8"x18	Rubber		10	50
1630 12G18	STRAIGHT THERMOSTATIC VALVE	1/2"x18	Rubber		10	50
1050 38G18	ANGLED VALVE	3/8"x18	Rubber		10	50
1050 12G18	ANGLED VALVE	1/2"x18	Rubber		10	50
1100 38G18	ANGLED LOCKSHIELD VALVE	3/8"x18	Rubber		10	50
1100 12G18	ANGLED LOCKSHIELD VALVE	1/2"x18	Rubber		10	50
1250 38G18	STRAIGHT VALVE	3/8"x18	Rubber		10	50
1250 12G18	STRAIGHT VALVE	1/2"x18	Rubber		10	50
1300 38G18	STRAIGHT LOCKSHIELD VALVE	3/8"x18	Rubber		10	50
1300 12G18	STRAIGHT LOCKSHIELD VALVE	1/2"x18	Rubber		10	50
1420 12G18	SINGLE-PIPE THERMOSTATIC VALVE	1/2"x18	Rubber		13	26
1420 34G18	SINGLE-PIPE THERMOSTATIC VALVE	3/4"x18	Rubber		13	26
1430 12G18	DOUBLE-PIPE THERMOSTATIC VALVE	1/2"x18	Rubber		13	26
1430 34G18	DOUBLE-PIPE THERMOSTATIC VALVE	3/4"x18	Rubber		13	26
1425 1250G18	STRAIGHT THERMOSTATIC SINGLE-PIPE VALVE, 40-50 mm ADJUSTABLE CENTRE DISTANCE	1/2"x18	Rubber		1	-
1425 1265G18	STRAIGHT THERMOSTATIC SINGLE-PIPE VALVE, 48-65 mm ADJUSTABLE CENTRE DISTANCE	1/2"x18	Rubber		1	-
1425 3450G18	STRAIGHT THERMOSTATIC SINGLE-PIPE VALVE, 40-50 mm ADJUSTABLE CENTRE DISTANCE	3/4"x18	Rubber		1	-
1425 3465G18	STRAIGHT THERMOSTATIC SINGLE-PIPE VALVE, 48-65 mm ADJUSTABLE CENTRE DISTANCE	3/4"x18	Rubber		1	-
1425 150DG18	STRAIGHT THERMOSTATIC SINGLE-PIPE VALVE, 40-50 mm ADJUSTABLE CENTRE DISTANCE	1"x18	Rubber		1	-
1425 150SG18	STRAIGHT THERMOSTATIC SINGLE-PIPE VALVE, 40-50 mm ADJUSTABLE CENTRE DISTANCE	1"x18	Rubber		1	-
1425 165DG18	STRAIGHT THERMOSTATIC SINGLE-PIPE VALVE, 48-65 mm ADJUSTABLE CENTRE DISTANCE	1"x18	Rubber		1	-
1425 165SG18	STRAIGHT THERMOSTATIC SINGLE-PIPE VALVE, 48-65 mm ADJUSTABLE CENTRE DISTANCE	1"x18	Rubber		1	-
1428 1250G18	ANGLED THERMOSTATIC SINGLE-PIPE VALVE, 40-50 mm ADJUSTABLE CENTRE DISTANCE	1/2"x18	Rubber		1	-
1428 1265G18	ANGLED THERMOSTATIC SINGLE-PIPE VALVE, 48-65 mm ADJUSTABLE CENTRE DISTANCE	1/2"x18	Rubber		1	-
1428 150DG18	ANGLED THERMOSTATIC SINGLE-PIPE VALVE, 40-50 mm ADJUSTABLE CENTRE DISTANCE	1"x18	Rubber		1	-
1428 150SG18	ANGLED THERMOSTATIC SINGLE-PIPE VALVE, 40-50 mm ADJUSTABLE CENTRE DISTANCE	1"x18	Rubber		1	-
1428 165DG18	ANGLED THERMOSTATIC SINGLE-PIPE VALVE, 48-65 mm ADJUSTABLE CENTRE DISTANCE	1"x18	Rubber		1	-
1428 165SG18	ANGLED THERMOSTATIC SINGLE-PIPE VALVE, 48-65 mm ADJUSTABLE CENTRE DISTANCE	1"x18	Rubber		1	-
1428 3450G18	ANGLED THERMOSTATIC SINGLE-PIPE VALVE, 40-50 mm ADJUSTABLE CENTRE DISTANCE	3/4"x18	Rubber		1	-
1428 3465G18	ANGLED THERMOSTATIC SINGLE-PIPE VALVE, 48-65 mm ADJUSTABLE CENTRE DISTANCE	3/4"x18	Rubber		1	-
1440 12G18	"GRT" THERMOSTATIC VALVE	1/2"x18	Rubber		5	40
1450 1212G18	"MONOSTILE" VALVE WITH Ø12 METAL PROBE	1/2"x18	Rubber		13	26
1450 3412G18	"MONOSTILE" VALVE WITH Ø12 METAL PROBE	3/4"x18	Rubber		13	26
1450 3414G18	"MONOSTILE" VALVE WITH Ø14 METAL PROBE	3/4"x18	Rubber		13	26
1450 114DG18	"MONOSTILE" VALVE WITH RIGHT CONNECTION AND Ø14 METAL PROBE	1"x18	Rubber		13	26
1450 114SG18	"MONOSTILE" VALVE WITH LEFT CONNECTION AND Ø14 METAL PROBE	1"x18	Rubber		13	26
1455 1212G18	"MONOTUBO" VALVE WITH Ø12 METAL PROBE	1/2"x18	Rubber		5	40
1455 3412G18	"MONOTUBO" VALVE WITH Ø12 METAL PROBE	3/4"x18	Rubber		5	40
1500 121RG18	"MONOSTILE" VALVE WITH ONE-RANK BENT ANGLED PROBE FOR PANEL RADIATORS	1/2"x18	Rubber		13	26
1500 122RG18	"MONOSTILE" VALVE WITH TWO-RANK BENT ANGLED PROBE FOR PANEL RADIATORS	1/2"x18	Rubber		13	26
1550 1212G18	"MONODET" VALVE WITH Ø12 METAL PROBE	1/2"x18	Rubber		10	20
1550 3412G18	"MONODET" VALVE WITH Ø12 METAL PROBE	3/4"x18	Rubber		10	20
1550 3414G18	"MONODET" VALVE WITH Ø14 METAL PROBE	3/4"x18	Rubber		10	20
1550 114DG18	"MONODET" VALVE WITH RIGHT CONNECTION AND Ø14 METAL PROBE	1"x18	Rubber		10	20
1550 114SG18	"MONODET" VALVE WITH LEFT CONNECTION AND Ø14 METAL PROBE	1"x18	Rubber		10	20
1600 12G18	"MONOTUBO" VALVE FOR CONVECTOR	1/2"x18	Rubber		3	24
1462 12G18	"MONOSTILE" VALVE WITH REVERSIBLE UNION FOR EXTERNAL PROBE	1/2"x18	Rubber		5	40
1472 12G18	"MONOSTILE" VALVE WITH REVERSIBLE UNION FOR EXTERNAL PROBE COMPLETE WITH ELBOW	1/2"x18	Rubber		5	40
1463 12G18	"MONOTUBO" VALVE WITH REVERSIBLE UNION FOR EXTERNAL PROBE	1/2"x18	Rubber		5	40
1473 12G18	"MONOTUBO" VALVE WITH REVERSIBLE UNION FOR EXTERNAL PROBE COMPLETE WITH ELBOW	1/2"x18	Rubber		5	40
1575 12G18	"MONOTUBO" "GRD" VALVE WITH INPUT FOR HEATING FLUID FROM ABOVE	1/2"x18	Rubber		5	40



Code	Description	size	gasket	€	box	pack
1585 12G18	"MONOTUBO" "GR" VALVE WITH INPUT FOR HEATING FLUID FROM ABOVE	1/2"x18	Rubber		5	40
1590 12G18	"MONOTUBO" "GR 3P" VALVE WITH INPUT FOR HEATING FLUID FROM ABOVE	1/2"x18	Rubber		5	40
1595 12G18	"MONOTUBO" "GRM" VALVE WITH INPUT FOR HEATING FLUID FROM ABOVE	1/2"x18	Rubber		5	40
8850 G1830	30 mm. STRAIGHT EXTENSION	(24x19)x18	Rubber		25	-
8850 G1835	35 mm. STRAIGHT EXTENSION	(24x19)x18	Rubber		25	-
8850 G1840	40 mm. STRAIGHT EXTENSION	(24x19)x18	Rubber		25	-
8900 35G18	SPECIAL ELBOW	(24x19)x18	Rubber		25	-